









Gelijkvloers

-  Luchtdoorvoering volgens NBN D50-001 (min. 70cm²) via spleet onder deur
-  Luchtdoorvoering volgens NBN D50-001 (min. 140cm²) via spleet onder deur
-  RTO (regelbare toevoer opening) volgens NBN D50-001
-  RAO (regelbare afvoer opening) A+ systeem

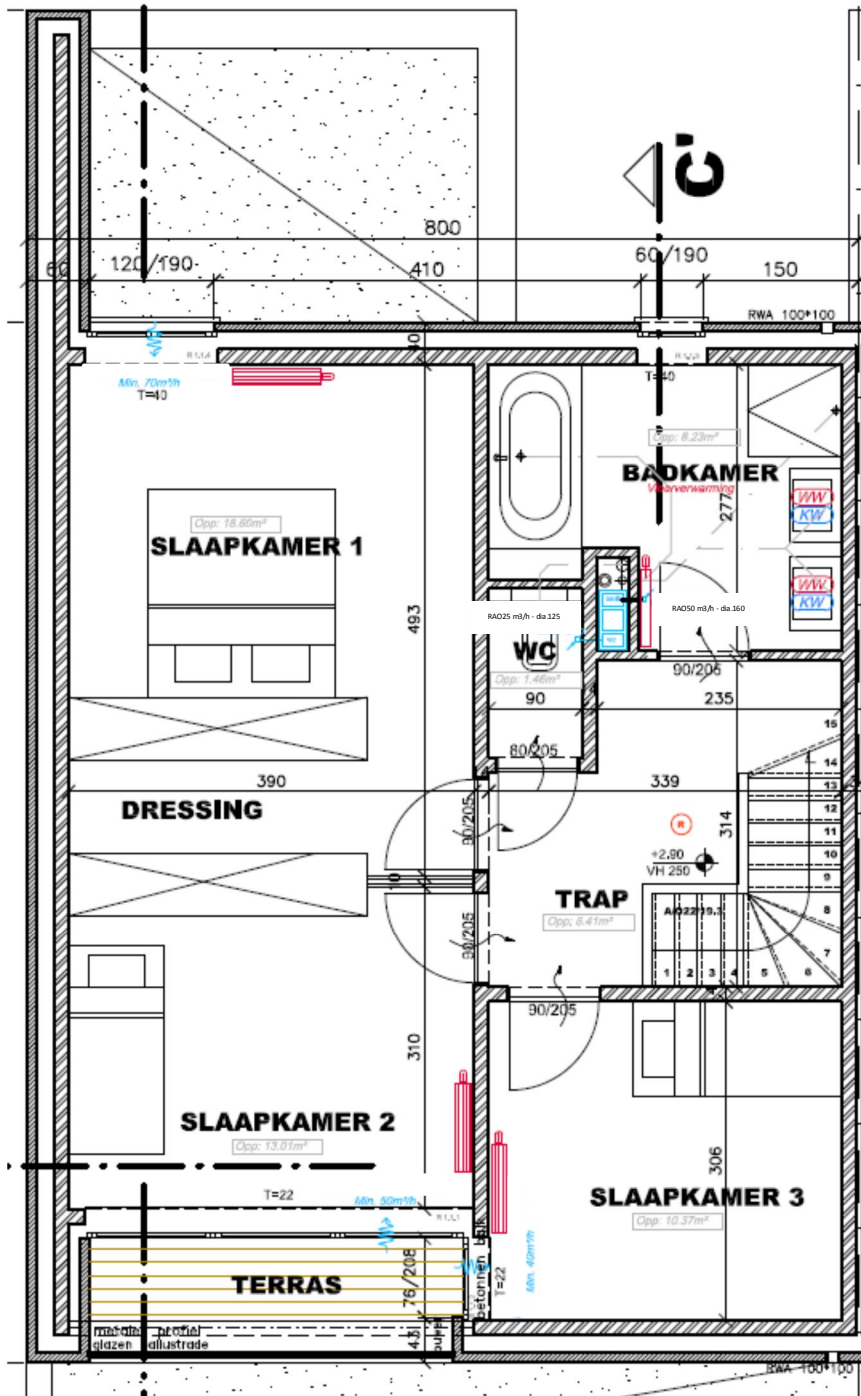

Verdieping

- 
 Luchtdoorvoeropening volgens NBN D50-001 (min. 70cm²) via spleet onder deur
- 
 Luchtdoorvoeropening volgens NBN D50-001 (min. 140cm²) via spleet onder deur
- 
 RTO (regelbare toevoer opening) volgens NBN D50-001
- 
 RAO (regelbare afvoer opening) A+ systeem

Detail afvoersysteem (horizontale + verticale snedes afvoerkanaal):

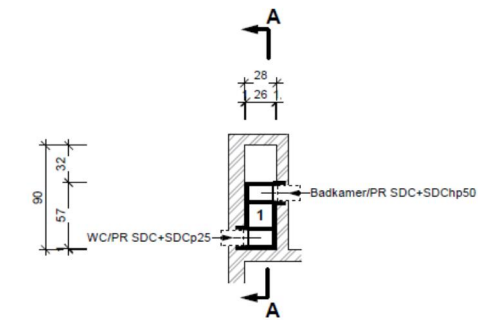

- 1ste verdieping -

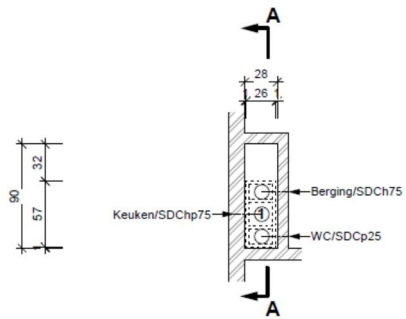

- Gelijkvloers -

